

# Side Entry

Item#:

- 739101 – Black
- 739102 – Beige

**B/L Description:** CL 250 NMFC 156600-03

**Material Process:** Blow-Molded with HDPE

**Standard Inclusions:** (1) removable serving tray holder  
(1) riverstone graphic (1) liner with molded-in handles (2) keys (2) clear graphic covers

Unit Size	Unit Size with Tray	Capacity	Weight
41" H 22" W 22" D	43" H 22" W 22" D	30-Gallons	43#

Carton Size	# Cartons Shipped	Dimensional Wt.	Carton Wt.
41 1/2"H 21 1/2"D 21 1/2"W	(1) Via UPS	99#	48#

- Ship at Dimensional Weight

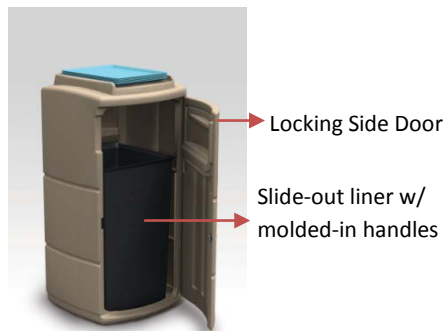
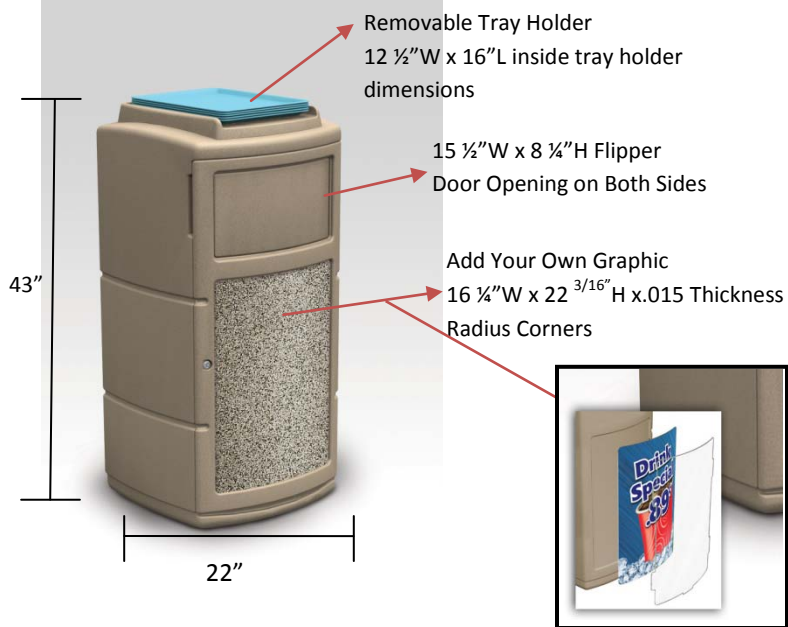

The Locking Side Entry waste container includes several options to fit in a variety of retail, business, or public environment. You can customize this unit by adding your own graphic with advertisements, logos, or a message for your customers.

- Large 30-gallon trash capacity, uses 39-gallon trash bags
- Two large flipper doors on either side contain odors and keep insects out.
- Locking side entry door
- Add washer side pod – item# 750801
- Easily empty tray contents through generous opening 15 1/2"W x 8 1/4" H
- Molded from long-lasting polyethylene; won't rust, dent or chip
- Plastic is approximately 1/8" thick
- Promote your message on either side of waste container; clear graphic cover protects your graphic
- Includes attractive riverstone graphic that can be removed to feature your own graphic
- Serving tray can be mounted to the top for food service environments
- Accommodates standard size trays (12 1/2"W x 16"L- inside tray holder dimensions)
- Made in U.S.A
- 1-year warranty



Product is ADA compliant



Optional security hardware is available

DCI Marketing, Inc.  
2727 West Good Hope Road  
Milwaukee, WI 53209  
PH: 800-782-7273 ■ FAX: 800-443-7489  
www.commercialzone.com ■ cpservice@dcim.com

**COMMERCIAL  
ZONE** PRODUCTS